

**CERTIFIED LAND CORNER RECORDATION**

DESCRIPTION OF CORNER EVIDENCE FOUND, AND ORIGINAL RECORD (If known)

LOCATION Found G.L.O. record monument, bent and mutilated. (Lower portion in place)  
 S.14 S.13 G.L.O. record - Iron post, 3 ft. long, 1 in. dia. (should read 2 ins. dia.),  
 S.23 S.24 2½ ft. in ground with brass cap. 1911  
 T.12N., R.62W.  
 6th P.M.

DESCRIPTION OF MONUMENT AND ACCESSORIES ESTABLISHED TO PERPETUATE THE ORIGINAL LOCATION OF THIS CORNER:

At the corner: Replaced G.L.O. monument by a 1½" dia. x 30" long iron pipe with brass cap.  
 Accessories: A 4" x 4" Redwood post, 4' long, 18" in the ground with sign bears S 89°57'45" E, 40.01 feet distant.

SKETCH, WITH COURSE AND DISTANCE TO ADJACENT CORNER IF DETERMINED IN THIS SURVEY.  
 (May Sketch or Paste Reproduction on Reverse Side.)

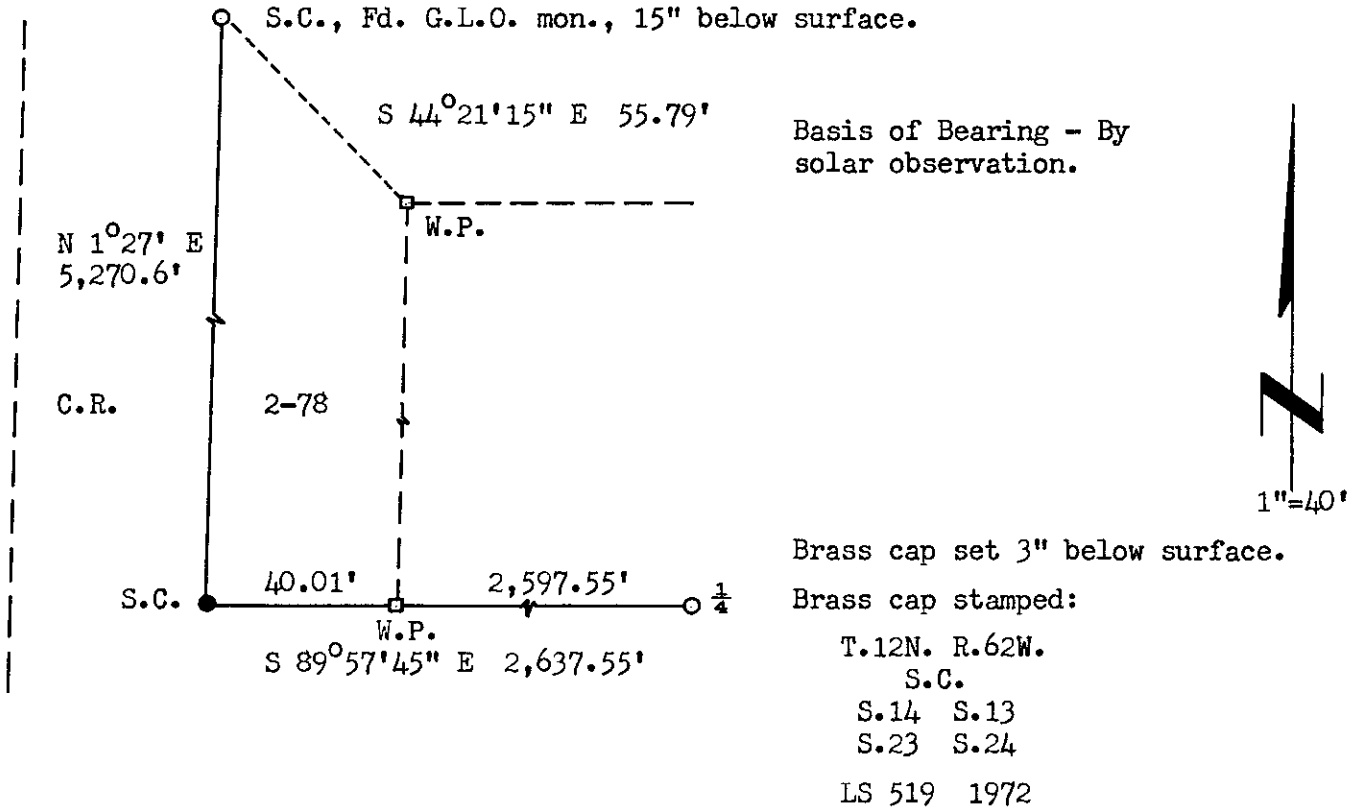

I, R.L. Hudson certify that I have carefully performed ~~or reviewed~~ the work done on the diagrammed corner as reported on this recordation form and approve the same.

R.L. Hudson Wyoming L.S. No. 519  
 Signature of Surveyor Registration No.

STATE OF WYOMING,  
 Office of Clerk and Recorder,  
 County of Darwin

This "corner record" was filed for record on the 30th day of October, 19 72, was noted on the cross-index plat and is assigned page No. 12-62, in book No. ONE

John A. Williams  
 County Official

|                       |          |          |            |
|-----------------------|----------|----------|------------|
| Cross Index No. _____ | T. _____ | R. _____ | Mer. _____ |
| _____                 | T. _____ | R. _____ | Mer. _____ |
| _____                 | T. _____ | R. _____ | Mer. _____ |
| _____                 | T. _____ | R. _____ | Mer. _____ |
| _____                 | T. _____ | R. _____ | Mer. _____ |
| _____                 | T. _____ | R. _____ | Mer. _____ |
| _____                 | T. _____ | R. _____ | Mer. _____ |

The State of Wyoming }  
County of Laramie } SS

This instrument was filed for record  
at 2:21 o'clock P.M. on the  
21th day of October  
A. D. 1912  
Book ..... of page .....

*Robert B. Williams*

..... Clerk of Deeds  
..... County